

GENERAL FEATURES

- **TORK series S4085 direct acting plate mounting solenoid valves are 3/2 way normally closed and designed for sub-base or mounting on the equipment**
- **Suitable for non-aggressive liquids (water, light oil (2E) etc...), gaseous fluids (air, iner gases etc...)**
- **Inlet and outlet ports placed asymmetricaly at the bottom of the body**
- Working Temperature: -10°C / +160°C
- Not suitable for use with dangerous fluids listed in Group 1
- Valve delivered with sealing o-rings
- **Don't require any differential pressure**
- Compact and low weight valve enabling easy and quick installation
- High reliability, quality and performance; long life, corrosion resistance
- TORK solenoid valves satisfy relevant 97/23/EC, Pressure Equipment Directive (PED) and 2006/95/EEC Low Voltage Directive (LVD)
- Some applications; burners
- Coils interchangeable
- Flow factor Kv of each valve is indicated, so that the flow Q can be calculated as a function of pressure
- Solenoid valves must be used with filtered fluids.
- Solenoid valve can be mounted in any position without affecting operation; vertical with coil upwards preferred.
- Standard pipe connection is G (BSP) (ISO 228-1) and on request; other pipe connections are available (NPT (ANSI 1.20.3))

Normally Closed

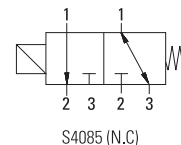

ELECTRICAL CHARACTERISTICS

Continuous Duty	: ED %100
Coil Insulation Class	: H (180°C)
Coil Impregnation	: Polyester Fiber Glass
Coil Encapsulation Material	: Fiber Glass Reinforced
Ambient Temperature	: from -10°C ; +60°C
Protection Degree	: IP 65 (EN 60529) with coil duly fitted with the plug connector
Electric Plug Connection	: DIN 46340 3-poles connectors (DIN 43650)
Connector Specification	: ISO 4400 / EN 175301-803, Form A, Spade plug (Cable Ø 6-8 mm)
Electrical Safety	: IEC 335
Standard Voltages	: For AC 12V, 24V, 48V, 110V, 230V For DC 12V, 24V, 48V, 110 V

Other voltages on request;
Voltage Tolerances : For AC %-15 ; %+10, For DC %-5 ; %+10
Frequency : 50 Hz, other frequencies on request; (60 Hz)
On request; connector with LED
Specify coil voltage with order

MATERIALS IN CONTACT WITH FLUIDS

Body	: Brass
Internal Parts	: Stainless Steel
Sealing	: RUBY
Shading Ring	: Copper
Seats	: Stainless Steel
Core Tube	: Stainless Steel
Springs	: Stainless Steel
On request; nickel plated body	
On request; sealing can be FPM (VITON)	

TECHNICAL FEATURES

Max Viscosity : 5°E (~37cSt or mm²/s)
Response Time : Opening Time:30 ms, Closing Time:30 ms
Maximum Allowable Pressure:20 bar
Fluids Temperature for FPM (VITON) from -10°C ; +160°C,

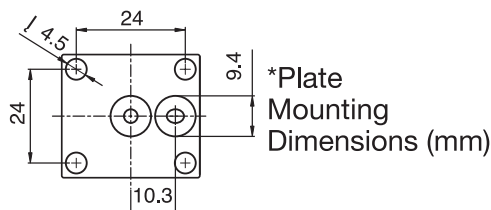
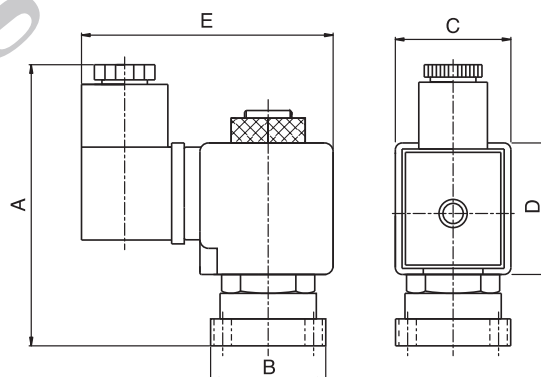

Dimensions (mm)

G	A	B	C	D	E
*	83	30	32	39	74

Valve Type / Order no	Connection Size	Orifice size	Pressure		KV	Fluid Temperature		Seal	Weight
			min	max		min	max		
S4085	G	mm	bar	bar	lt/min	°C			(kg)
S 4 0 8 5 . 0 1 8	G	1.8	0	30	1-2=1,35 , 2-3=1,35	-10 160		RUBY	0.5

Useful Informations

1 bar:14,5 PSI:10 mH₂O :10 N/cm² :1 kg/cm²:100000 Pa, 1 PSI:69 mbar,1 m³/h:4,405 GPM:16,7 L/d 1 Gallon / minute:0,227 m³/h, 0°C:89,6 F
Sealings:FPM (VITON);Fluoro-Carbon Elastomer, RUBY:Synthetic Corundum